

# HYDRANT CLAMP

The **R2M HYDRANT CLAMP** is a high quality, easily installed single solution external fitting, designed to make safe a reported issue of corrosion and potential failure of the series 19 Hydrant inlet/outlet securing clip. This can lead to the risk of the outlet adapter and main chamber unscrewing during operation and fitment of external pressure pipe apparatus, causing a serious health and safety risk to operators.

The fitting incorporates two female hex shapes which interlock with the 'at risk' chambers of the hydrant. It is designed specifically to fit the shape and contours of the hydrant, performing two key safety functions:

1. Prevention of the original manufacturer's locking device from unscrewing.
2. Clamps both chambers vertically, in order that they should not rise upwards, if they were to unscrew.

It also performs two additional safety functions in that it prevents the original manufacturer's locking device from unscrewing, as well as holds both chambers vertically, in order that they should not rise upwards if they were to unscrew. After fitment, the hydrant can be utilised in the normal way.

*Patent App. 2006499.4*

## INNOVATION

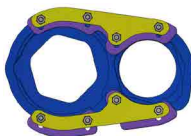

CAD designed v6 fits the hydrant and engages with the hexagons to resist any rotation or untightening of either chamber (200Nm for the main chamber and 120Nm for the outlet). Captive locking tabs secure it in place firmly.

## INSTALLATION

Installation of the **R2M HYDRANT CLAMP** means a Series 19 Hydrant which is deemed as posing a risk, is made fully safe. The fitting is installed under live conditions, without interruption to customer supply and requiring no excavation or reinstatement. The integrity, usability and longevity of the hydrant is enhanced and after installation of the fitting, the hydrant can be fully utilised in the normal way.

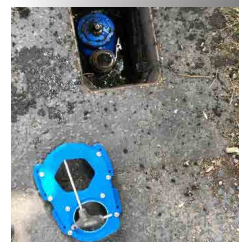

## RESEARCH AND EVALUATION

Initial field trials of the stainless steel fabricated version (v3) which proved the concept, functionality and ease of installation without need for any excavation or interruption of customer's supplies.

This progressed to the V6 model with an improved shape being more ergonomic and even easier to install.